







PLAN SHOWING THE PROPOSED RESIDENTIAL BUILDING AT THAI MOOGAMBIGAI NAGAR ROAD, PERUNGALATHUR, CHENNAI - 600 124. COMPRAISED IN S.NO. 108 / 1 A, 1B, & 2A OF PERUNGALATHUR VILLAGE, TAMBARAM TALUK PERUNGALATHUR PANCHAYATH UNION, KANCHIPURAM DISTRICT.

Specifications:  
 Foundation : Column footing  
 Flooring : Mosaic Flooring  
 Super Structure : B.W in C.M 1:1 for R.C.C 1:2:4 in Lintel Beams sunshade etc.  
 Roof R.C.C 1:2:4 : with required finish  
 Weathering course : Brick jolly line conc. below the weathering tiles  
 Joinery : Best Indian Country Wood  
 Finishes : Exterior & interior painted with cement paint.

Schedule of Joineries.

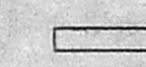
MD36	1.07 X 2.13	Panelled Door
D4	1.22 X 2.13	Panelled Door
D3	0.90 X 2.13	Panelled Door
D26	0.76 X 2.13	Panelled Door
DIO4	1.35 X 2.13	Door Open
W16	0.60 X 1.98	French Window
W4	1.22 X 1.35	Window
KW3	0.90 X 1.35	Kitchen Window
RS	3.05 X 2.13	Rolling Shutter
V2	0.60 X 0.60	Ventilator

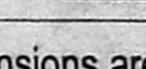
Colour Index  
 Proposed   
 Boundary   
 Road   
 All Dimensions are in Metre.  
 Scale : 1:100

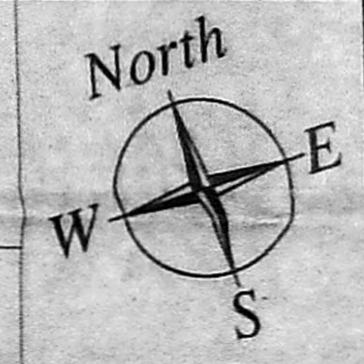

Kavita N Shek  
 Ajita Shek  
 Applicant Signature.

R.K. CHANDRAN, B.E., M.E. (Struct)  
 STRUCTURAL ENGINEER  
 33, 3rd Floor, 43, Pantheon Road, Egmore,  
 Chennai - 600 008. Ph: 28554282, 28410888  
 Email: r.k.chandran@rediffmail.com

SIVA ANBARASAN  
 March (USA, England), ALLA  
 Regd. Architect, C.A. No. 10789, R.A. No. 10885  
 RAJ/G-11/17/03/037  
 ANBU & FAIZAL  
 33, 3rd Floor, 43, Pantheon Road, Egmore,  
 Chennai - 600 008. Ph: 28554282, 28410888  
 Email: siva.anbarasan@gmail.com

Architect Signature

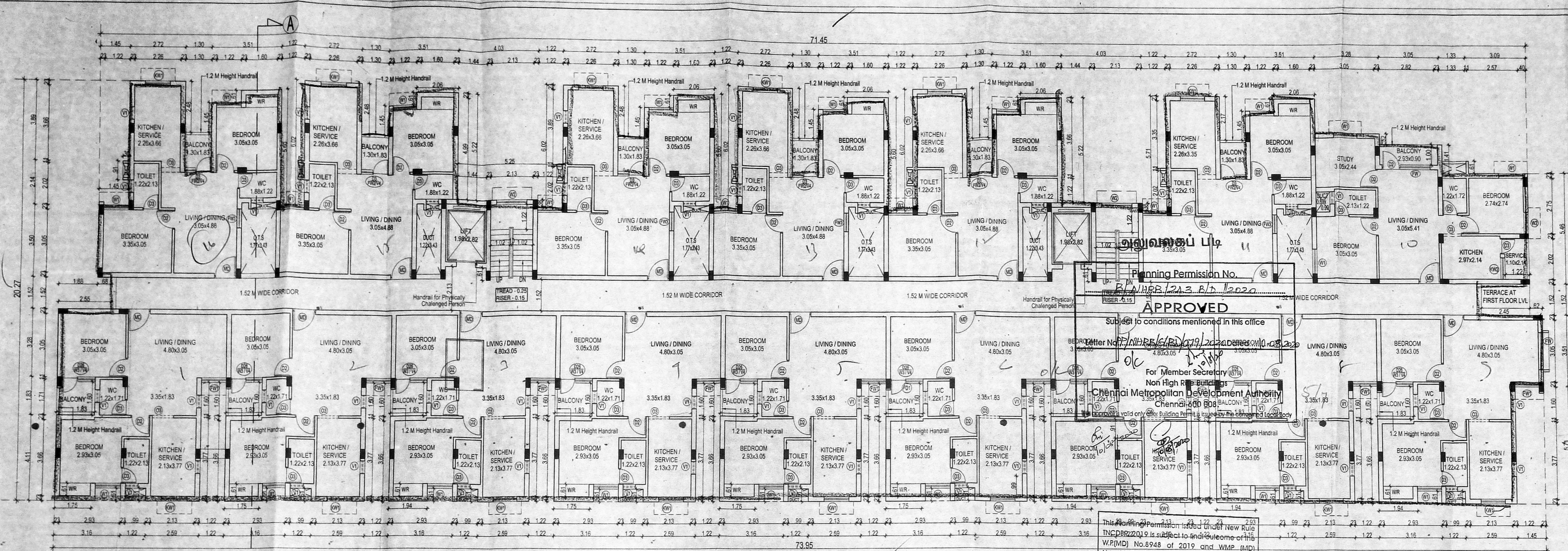

Typical Floor Plan  
 [1st, 2nd, 3rd & 4th]

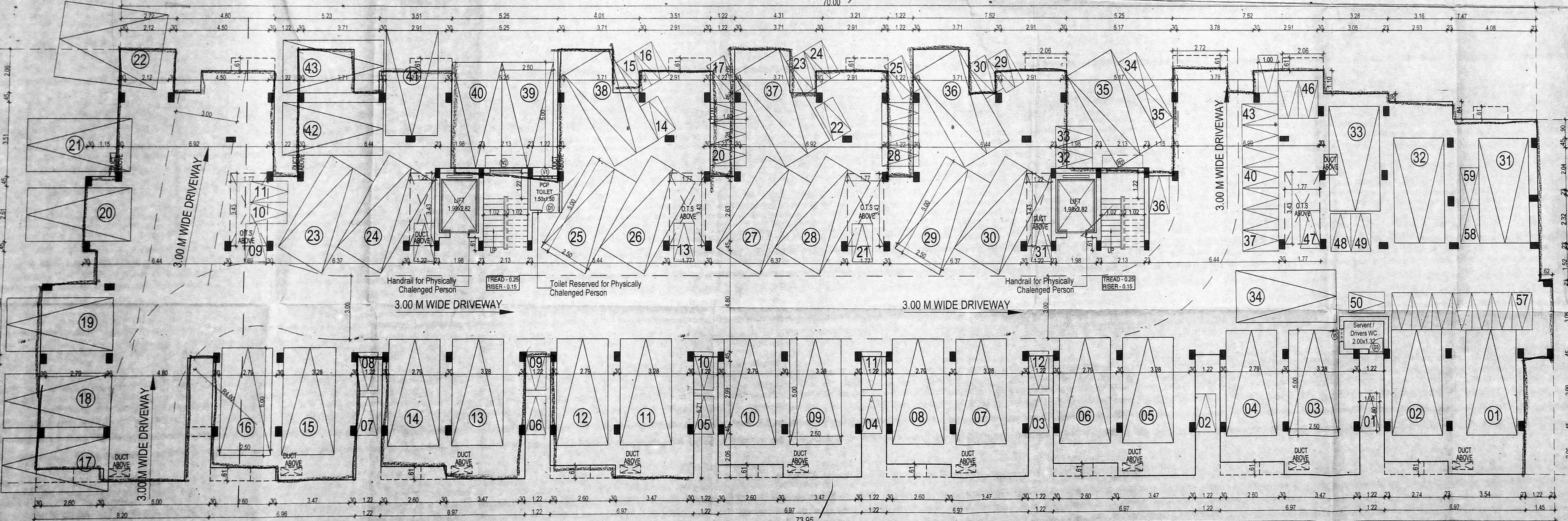

Stilt Floor Plan







